

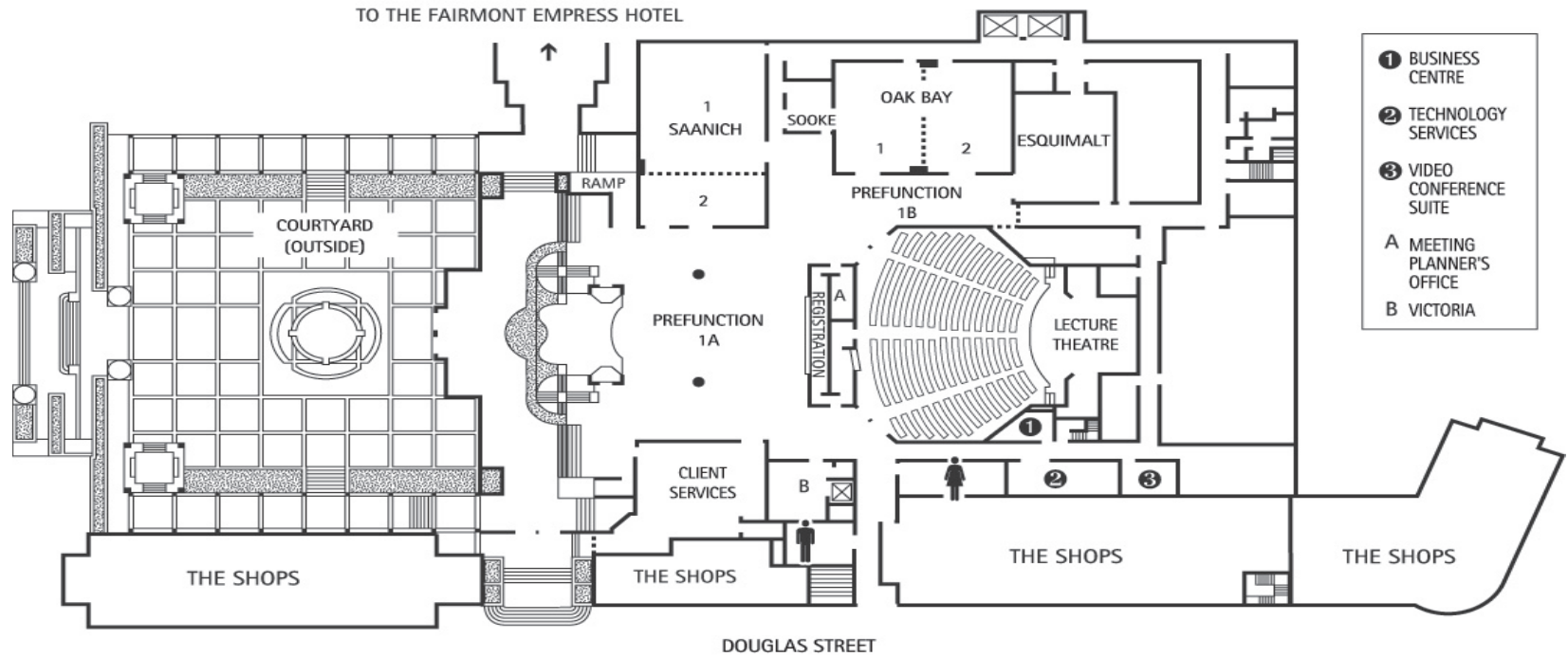

VICTORIA
CONFERENCE
CENTRE



LEVEL ONE FUNCTION SPACE

	DIMENSIONS	SQ. FT	OCCUPANCY*		BRD	H/S	U	BANQ	REC	10X10	8X10	8X8	TT	PB	
			T/S	C/R											
Lecture Theatre		3700	400												
Saanich	61'x35'x9'5"	2135	180	132		72	60	150	225	10	10	12	23	20	
Saanich 1	43'x35'x9'5"	1505	126	84		54	54	120	150				18	16	
Saanich 2	35'x18'x9'5"	630	50	36	28			30	65				6	6	
Sooke	18'x13'x9'5"	234			10			10							
Oak Bay	50'x37'x9'5"	1850	168	96		56	42	120	200	8	10	11	20	20	
Oak Bay 1	37'x25'x9'5"	925	70	54		36	28	60	90				10	10	
Oak Bay 2	37'x25'x9'5"	925	70	54		36	28	60	90				10	10	
Esquimalt	38'x28'x9'5"	1064	84	60		42	32	60	110	6	6	6	14	10	
Victoria	24'x16'x9'5"	384	35	20	18			20	40						
Prefunction 1	Ceiling Ht. 9'10"	6500						240	400	11	13	16	23	25	
Prefunction 1A	Ceiling Ht. 9'10"	4875						170	300	9	8	8	20	17	
Prefunction 1B	Ceiling Ht. 9'10"	1625						70	100	2	2	2	3	8	
Registration Area		370													
Meeting Planner's Office	13'x6'x7'	78													
Courtyard		7730						340	700						
Totem Prefunction	110'x23'	2530							250						
Videoconference Suite	17'5"x11'5"x8'	209			10										

*Occupancy numbers are based on maximum capacity and will be reduced according to additional function room requirements, i.e. staging, audiovisual, dance floor, etc.



**VICTORIA
CONFERENCE
CENTRE**

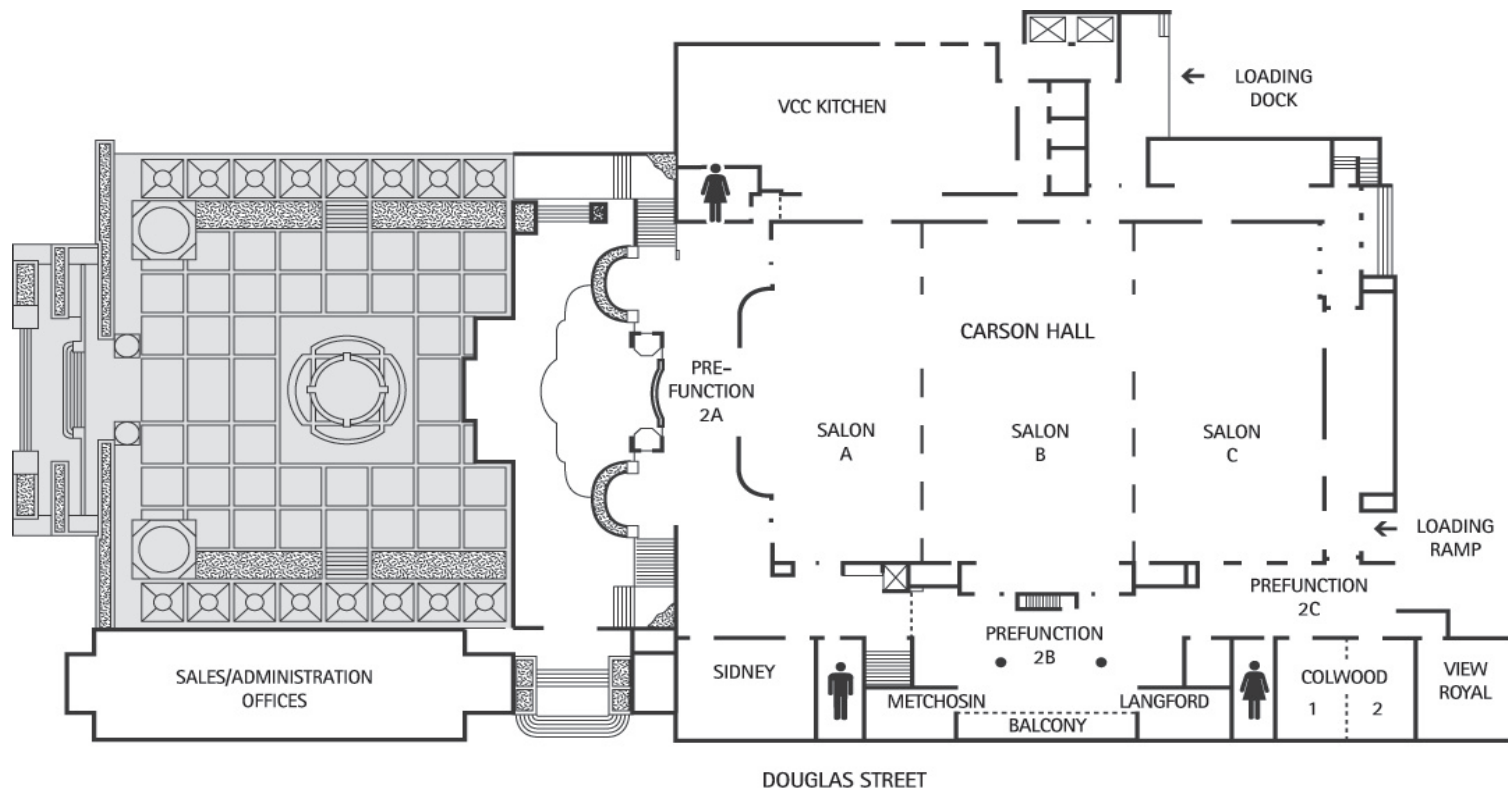

LEVEL TWO FUNCTION SPACE

	DIMENSIONS	SQ. FT.	OCCUPANCY*												
			T/S	C/R	BRD	H/S	U	BANQ	REC	10X10	8X10	8X8	TT	PB	
Carson Hall	145'x96'x23'	14689 (incl. alcove)	1450	750					1080	2000	89	96	122	132	132
Salon A	96'x48'x23'	5056 (incl. alcove)	450	252		82	64	360	600	29	30	36	52	44	
Salon B	96'x49'x23'	5025 (incl. alcove)	450	270		82	64	360	600	26	34	42	46	40	
Salon C	96'x48'x23'	4608	400	252		82	64	340	600	25	32	38	46	40	
Salon AB	97'x96'x23'	10081 (incl. alcove)	1040	588				850	1200	63	67	85	98	92	
Salon BC	97'x96'x23'	9633 (incl. alcove)	1008	540				810	1200	58	62	79	92	88	
Sidney	35'x27'10'	945	85	60		40	32	60	110	4	4	6	10	10	
Metchosin	24'x15'x9'	360	30	18	20			20	30		2	2	3	4	
Langford	24'x15'x9'	360	30	18	20			20	30		2	2	3	4	
Colwood	35'x27'x10'6"	945	84	57	20	40	32	60	110	4	4	5	10	10	
Colwood1	27'x17'5"x10'6"	472	40	24	20		20	30	50	2	2	3	6	5	
Colwood 2	27'x17'5"x10'6"	472	40	24	20		20	30	50	2	2	3	6	5	
View Royal	28'x24'x9'	672	60	36	22	28		40	60	3	3	5	6	8	
Prefunction 2		6880						170	800	11	11	13	18	23	
Prefunction 2A	Ceiling Ht. 9'7"	2900						90	400	6	6	7	10	12	
Prefunction 2B	Ceiling Ht. 8'9"	2800						70	400	5	5	6	18	13	
Prefunction 2C	Ceiling Ht. 8'9"	1180						10					1	1	

*Occupancy numbers are based on maximum capacity and will be reduced according to additional function room requirements, i.e. staging, audiovisual, dance floor, etc.